

Strutcatcher

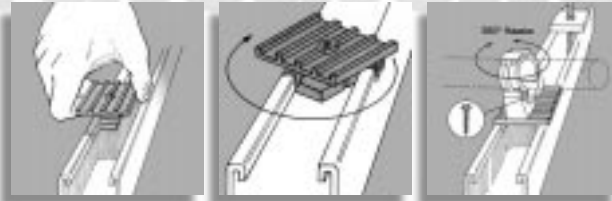

Insert Strutcatcher into strut.

Twist Strutcatcher 90 degrees and it locks into place.

Mount Clic-x onto Strutcatcher with a screw.

how does it work?



Mount Clic-x to surface.

Insert pipe, tube, conduit or cable into the open Clic-x.

Apply slight pressure to the tubular member and the jaws close and lock.

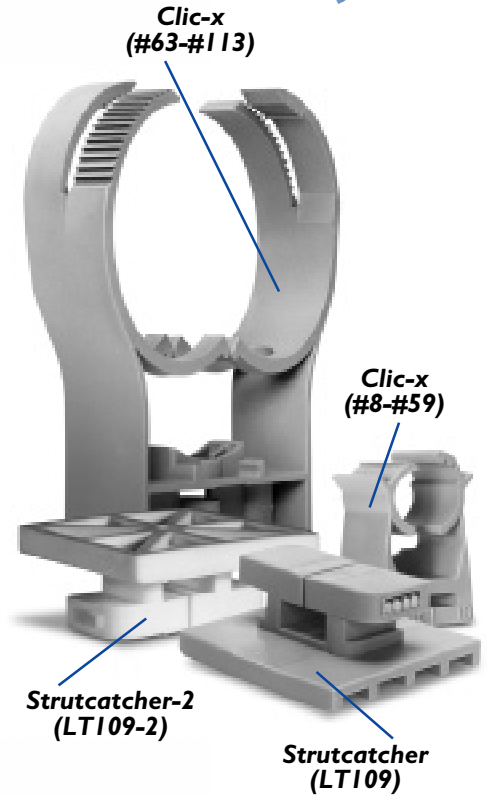

The demanding applications which the original Clic product line saw in service will be expanded with the new Clic-X product.

Benefits

The Xenoy has improved weatherability due to a substantial UV inhibitor in the material.

- **Corrosion Resistance:** Xenoy rates as a GE top performer in this area.
- **Flash Ignition:** 660-690°F
350-365°C
- **Self Ignition:** 752-932°F
400-500°C
- **Toxicity:** none

- **Phosphates:** none
- **Halogens:** none
- **Gases Released:** carbon monoxide and carbon dioxide
- **Tensile Test:** UL 94HB non-flame retardant
- **Thermal Conductivity:** excellent
- **Non-Magnetic Properties:** excellent
- **FDA:** both alloys polyester and lexan polycarbonate are listed. Combined they are not listed.
- **Fungus Growth:** will not promote

For more information and support data, visit our website under Technical Data.

The Clic-x above right shows original design features, with self-clamping pivot hinges and oval mounting hole for easy installation. Clic-x model #8 - #59 (diameters .295" - 2").

The larger-diameter Clic-x, above left, features a double-locking band for added support. Clic-x model #63 - #113 (diameters 2-1/2" - 4").

The Strutcatcher (LT109), above right) allows on site prefabrication and strut installations for all Clic-x applications.

The Strutcatcher-2 (LT109-2), above left, works the same as LT109 but is recommended for light duty applications.

The Clic-x / Strutcatcher System, offered only by Litchfield International, uses patented technology, advanced design and high performance materials to secure all your pipe/tube/conduit/cable projects.

get all the answers at

www.litchfieldinternational.com

Each Clic-x is:

- **highly versatile** – Clic-x works with all types of pipe, tube, conduit and cable
- **easy to use** – requiring only one installer
- **economical** – installation time is routinely reduced by up to 35%
- **highly adaptable** – Clic-x can be attached to wood, concrete, brick, cinder block, sheet metal, fiberglass and strut; virtually any surface or structural member
- **corrosion-resistant** – made from durable Xenoy 5730
- **reusable** – design changes can be easily accommodated
- **inventory reducing** – it eliminates stocking the same support in several metals
- **efficiency-minded** – usable over 3/8", 1/2", and 3/4" insulation
- **free of galvanic action, noise abatement, dielectrics and is non-magnetic**
- **convenient** – allows prefabrication of trapeze hangers
- **accommodating** – allows expansion and contraction of piping and conduit systems



**How can so few parts
do so much?**

**Visit our website
for complete
details and
order your
FREE
CLIC-X
SAMPLES!**

CLIC-X – The One Piece Automatic Locking Pipe/Tube/Conduit/Cable Support and Hanger.

Insert pipe, tube, conduit or cable into the open Clic-x, apply slight pressure to the tubular member and the jaws close and lock. A sharp “clik” indicates the pipe/tube/conduit/cable is securely fastened. **It's that simple.**

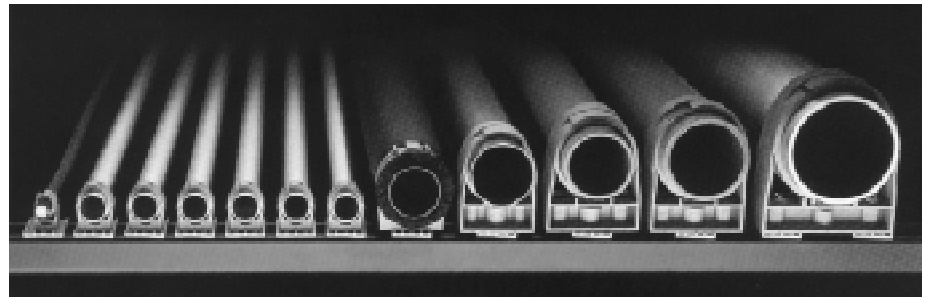

Clic-x & Strutcatcher used for strut installation.

Related Information:

See page 5 for **Strutcatcher** and **Strutcatcher2** product information and page 7 for accessories for added versatility.

See page 9 for test-loading information.

See page 12 and 13 for centerline drawings and product dimensions.

